

INDUSTRIAL FITTINGS - clips, clamps, ferrules

DIN 3015 clamps

Designed for quick, easy, durable and esthetic assembly of pipes, cables and hoses in several branches of industry, including land and marine installations. Manufactured according to DIN 3015 specifications. Mounted on a base construction by welding the lower plate, screwing or fixing it on rails.

Supplied in 3 versions:

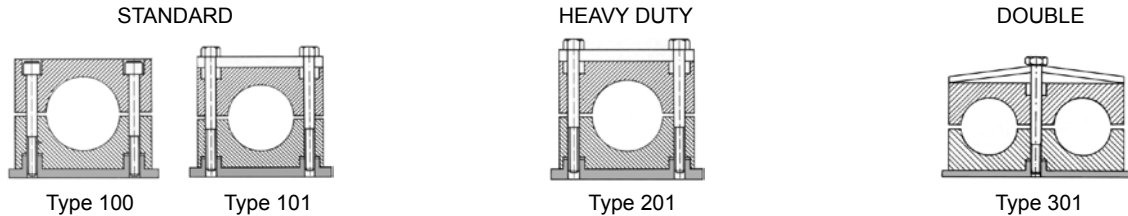

Clamp material (clamp body):

material	symbol	colour	working temp.
polypropylene	PP	green	from -30°C up to +90°C
polyamide PA66 with addition of 20% glass fibre - self extinguishing	PA	black	from -40°C up to +180°C
rubber	RB	black	from -40°C up to +80°C
aluminium	AL	silver	up to +350°C

The surface of the inner part of a clamp is grooved as a standard. Clamps with smooth surface of the inner part are also available. Joining parts (screws, plates) are made of zinc-plated carbon steel, weld parts of carbon steel. Clamps with parts made of stainless steel are available on request. To order separated clamp body, please add X to the code (e.g. TC-PP100-006X).

To obtain detailed information about physical, mechanical, thermal and electrical properties of a particular material, please contact Technical Department of TUBES INTERNATIONAL®.

Clamps mounted on a base construction and other elements of the system

Clamps are mounted on a base construction by welding the lower plate followed by the assembly of a clamp and pipe. The clamps with already mounted body must not be welded! Keep proper distance between subsequent clamps. If a pipe is bent, assemble clamps as close as possible to the pipe bend. After tightening screws (with an appropriate torque) of clamp on the pipe, two halves of clamps should not be in contact with each other.

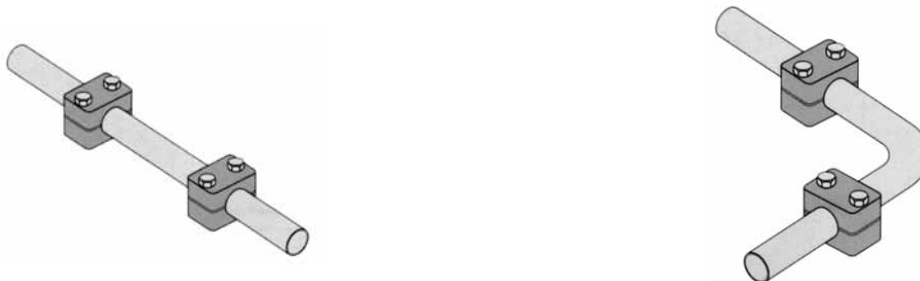

Optional system elements for assembly by welding or screwing, e.g.:

- extended, angular and bridge plates,
- double and multiple mounting plates,
- rails for multiple mounting,
- units for stack mounting (one onto the other).

For a detailed clamps offer, contact Sales or Technical Department of TUBES INTERNATIONAL®.

INDUSTRIAL FITTINGS - clips, clamps, ferrules

100 type

0 group

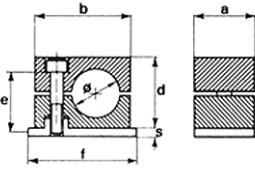

1÷6 group

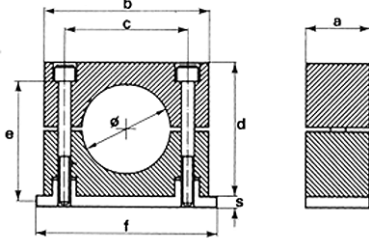

DIN 3015 standard clamp

Clamp material: Green polypropylene (also: self-extinguishing polyamide, aluminium, rubber)

Bolts material: Galvanized steel

Base material: Carbon steel

Designed for quick, easy, durable and esthetic assembly of pipes, cables and hoses. Apart from standard metal parts, extended plates, rails and bolts for clamp sets are available as well. For proper selection of elements, contact Sales or Technical Department of TUBES INTERNATIONAL®.

code (polypropylene)	code (polyamide)	code (rubber)	code (aluminium)	group	pipe O.D. [mm]	dimensions														
						a	b	c	d	f	s	e								
TC-PP100-006	TC-PA100-006	-	-	0	6	30	28	-	27	32	3	M6 x 20								
TC-PP100-008	TC-PA100-008	-	-		8															
TC-PP100-010	TC-PA100-010	-	-		10															
TC-PP100-012	TC-PA100-012	-	-		12															
TC-PP100-106	TC-PA100-106	TC-RB100-106	TC-AL100-106	1	6	30	34	20	27	42	3	M6 x 20								
TC-PP100-106.4	TC-PA100-106.4	TC-RB100-106.4	-		6.4															
TC-PP100-108	TC-PA100-108	TC-RB100-108	TC-AL100-108		8															
TC-PP100-109.5	TC-PA100-109.5	TC-RB100-109.5	-		9.5															
TC-PP100-110	TC-PA100-110	TC-RB100-110	TC-AL100-110		10															
TC-PP100-112	TC-PA100-112	TC-RB100-112	TC-AL100-112		12															
TC-PP100-212.7	TC-PA100-212.7	TC-RB100-212.7	-	2	12.7	30	40	26	33	48	3	M6 x 25								
TC-PP100-213.5	TC-PA100-213.5	TC-RB100-213.5	-		13.5															
TC-PP100-214	TC-PA100-214	TC-RB100-214	TC-AL100-214		14															
TC-PP100-215	TC-PA100-215	TC-RB100-215	TC-AL100-215		15															
TC-PP100-216	TC-PA100-216	TC-RB100-216	TC-AL100-216		16															
TC-PP100-217.2	TC-PA100-217.2	TC-RB100-217.2	TC-AL100-217.2		17.2															
TC-PP100-218	TC-PA100-218	TC-RB100-218	TC-AL100-218		18															
TC-PP100-219	TC-PA100-219	TC-RB100-219	-		19															
TC-PP100-319	TC-PA100-319	TC-RB100-319	TC-AL100-319		3								19	30	48	33	35	55	3	M6 x 30
TC-PP100-320	TC-PA100-320	TC-RB100-320	TC-AL100-320										20							
TC-PP100-321.3	TC-PA100-321.3	TC-RB100-321.3	TC-AL100-321.3	21.3																
TC-PP100-322	TC-PA100-322	TC-RB100-322	TC-AL100-322	22																
TC-PP100-325	TC-PA100-325	TC-RB100-325	TC-AL100-325	25																
TC-PP100-325.4	TC-PA100-325.4	TC-RB100-325.4	-	25.4																
TC-PP100-426.9	TC-PA100-426.9	TC-RB100-426.9	TC-AL100-426.9	4	26.9	30	57	40	42	62	3	M6 x 35								
TC-PP100-428	TC-PA100-428	TC-RB100-428	TC-AL100-428		28															
TC-PP100-430	TC-PA100-430	TC-RB100-430	TC-AL100-430		30															
TC-PP100-432	TC-PA100-432	TC-RB100-432	TC-AL100-432		32															
TC-PP100-532	TC-PA100-532	TC-RB100-532	TC-AL100-532	5	32	30	68	52	58	74	3	M6 x 50								
TC-PP100-533.7	TC-PA100-533.7	TC-RB100-533.7	TC-AL100-533.7		33.7															
TC-PP100-535	TC-PA100-535	TC-RB100-535	TC-AL100-535		35															
TC-PP100-538	TC-PA100-538	TC-RB100-538	TC-AL100-538		38															
TC-PP100-540	TC-PA100-540	TC-RB100-540	TC-AL100-540		40															
TC-PP100-542	TC-PA100-542	TC-RB100-542	TC-AL100-542		42															
TC-PP100-542.4	TC-PA100-542.4	TC-RB100-542.4	-		42.4															
TC-PP100-545	TC-PA100-545	TC-RB100-545	TC-AL100-545		45															
TC-PP100-644.5	TC-PA100-644.5	TC-RB100-644.5	TC-AL100-644.5	6	44.5	30	86	66	66	88	3	M6 x 60								
TC-PP100-648.3	TC-PA100-648.3	TC-RB100-648.3	TC-AL100-648.3		48.3															
TC-PP100-650.8	TC-PA100-650.8	TC-RB100-650.8	TC-AL100-650.8		50.8															

INDUSTRIAL FITTINGS - clips, clamps, ferrules

101 type

0 group

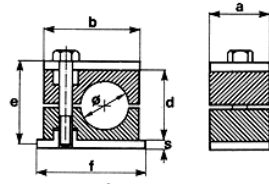

1÷6 group

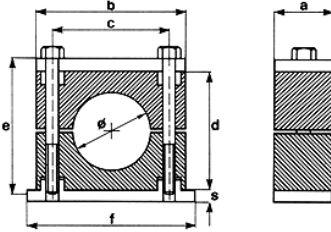

DIN 3015 standard clamp

Clamp material: Green polypropylene (also: self-extinguishing polyamide, aluminium, rubber)

Bolts material: Galvanized steel

Plate material: Galvanized steel

Base material: Carbon steel

Designed for quick, easy, durable and esthetic assembly of pipes, cables and hoses. Apart from standard metal parts, extended plates, rails and bolts for clamp sets are available as well. For proper selection of elements, contact Sales or Technical Department of TUBES INTERNATIONAL®.

code (polypropylene)	code (polyamide)	code (rubber)	code (aluminium)	group	pipe O.D. [mm]	dimensions														
						a	b	c	d	f	s	e								
TC-PP101-006	TC-PA101-006	-	-	0	6	30	28	-	27	32	3	M6 x 30								
TC-PP101-008	TC-PA101-008	-	-		8															
TC-PP101-010	TC-PA101-010	-	-		10															
TC-PP101-012	TC-PA101-012	-	-		12															
TC-PP101-106	TC-PA101-106	TC-RB101-106	TC-AL101-106	1	6	30	34	20	27	42	3	M6 x 30								
TC-PP101-106.4	TC-PA101-106.4	TC-RB101-106.4	-		6.4															
TC-PP101-108	TC-PA101-108	TC-RB101-108	TC-AL101-108		8															
TC-PP101-109.5	TC-PA101-109.5	TC-RB101-109.5	-		9.5															
TC-PP101-110	TC-PA101-110	TC-RB101-110	TC-AL101-110		10															
TC-PP101-112	TC-PA101-112	TC-RB101-112	TC-AL101-112		12															
TC-PP101-212.7	TC-PA101-212.7	TC-RB101-212.7	-	2	12.7	30	40	26	33	48	3	M6 x 35								
TC-PP101-213.5	TC-PA101-213.5	TC-RB101-213.5	-		13.5															
TC-PP101-214	TC-PA101-214	TC-RB101-214	TC-AL101-214		14															
TC-PP101-215	TC-PA101-215	TC-RB101-215	TC-AL101-215		15															
TC-PP101-216	TC-PA101-216	TC-RB101-216	TC-AL101-216		16															
TC-PP101-217.2	TC-PA101-217.2	TC-RB101-217.2	TC-AL101-217.2		17.2															
TC-PP101-218	TC-PA101-218	TC-RB101-218	TC-AL101-218		18															
TC-PP101-219	TC-PA101-219	TC-RB101-219	-		19															
TC-PP101-319	TC-PA101-319	TC-RB101-319	TC-AL101-319		3								19	30	48	33	35	55	3	M6 x 40
TC-PP101-320	TC-PA101-320	TC-RB101-320	TC-AL101-320										20							
TC-PP101-321.3	TC-PA101-321.3	TC-RB101-321.3	TC-AL101-321.3	21.3																
TC-PP101-322	TC-PA101-322	TC-RB101-322	TC-AL101-322	22																
TC-PP101-325	TC-PA101-325	TC-RB101-325	TC-AL101-325	25																
TC-PP101-325.4	TC-PA101-325.4	TC-RB101-325.4	-	25.4																
TC-PP101-426.9	TC-PA101-426.9	TC-RB101-426.9	TC-AL101-426.9	4	26.9	30	57	40	42	62	3	M6 x 45								
TC-PP101-428	TC-PA101-428	TC-RB101-428	TC-AL101-428		28															
TC-PP101-430	TC-PA101-430	TC-RB101-430	TC-AL101-430		30															
TC-PP101-432	TC-PA101-432	TC-RB101-432	TC-AL101-432		32															
TC-PP101-532	TC-PA101-532	TC-RB101-532	TC-AL101-532	5	32	30	68	52	58	74	3	M6 x 60								
TC-PP101-533.7	TC-PA101-533.7	TC-RB101-533.7	TC-AL101-533.7		33.7															
TC-PP101-535	TC-PA101-535	TC-RB101-535	TC-AL101-535		35															
TC-PP101-538	TC-PA101-538	TC-RB101-538	TC-AL101-538		38															
TC-PP101-540	TC-PA101-540	TC-RB101-540	TC-AL101-540		40															
TC-PP101-542	TC-PA101-542	TC-RB101-542	TC-AL101-542		42															
TC-PP101-542.4	TC-PA101-542.4	TC-RB101-542.4	-		42.4															
TC-PP101-545	TC-PA101-545	TC-RB101-545	TC-AL101-545		45															
TC-PP101-644.5	TC-PA101-644.5	TC-RB101-644.5	TC-AL101-644.5	6	44.5	30	86	66	66	88	3	M6 x 70								
TC-PP101-648.3	TC-PA101-648.3	TC-RB101-648.3	TC-AL101-648.3		48.3															
TC-PP101-650.8	TC-PA101-650.8	TC-RB101-650.8	TC-AL101-650.8		50.8															

INDUSTRIAL FITTINGS - clips, clamps, ferrules

201 type

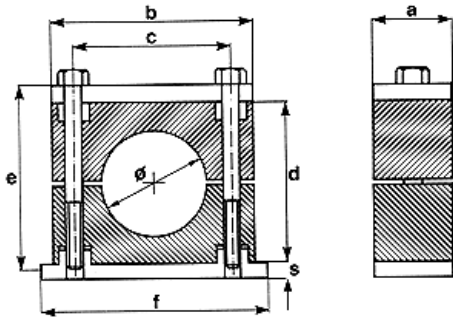

DIN 3015 heavy duty clamp

Clamp material: Green polypropylene (also: self-extinguishing polyamide, aluminium, rubber)

Bolts material: Galvanized steel

Plate material: Galvanized steel

Base material: Carbon steel

Designed for quick, easy, durable and esthetic assembly of pipes, cables and hoses. Apart from standard metal parts, extended plates, rails and bolts for clamp sets are available as well. For proper selection of elements, contact Sales or Technical Department of TUBES INTERNATIONAL®.

code (polypropylene)	code (polyamide)	code (rubber)	code (aluminium)	group	pipe O.D. [mm]	dimensions						
						a	b	c	d	f	s	e
TC-PP201-106	TC-PA201-106	TC-RB201-106	TC-AL201-106	1	6	30	55	33	32	73	8	M10 x 45
TC-PP201-106.4	TC-PA201-106.4	TC-RB201-106.4	TC-AL201-106.4		6.4							
TC-PP201-108	TC-PA201-108	TC-RB201-108	TC-AL201-108		8							
TC-PP201-109.5	TC-PA201-109.5	TC-RB201-109.5	-		9.5							
TC-PP201-110	TC-PA201-110	TC-RB201-110	TC-AL201-110		10							
TC-PP201-112	TC-PA201-112	TC-RB201-112	TC-AL201-112		12							
TC-PP201-112.7	TC-PA201-112.7	TC-RB201-112.7	TC-AL201-112.7		12.7							
TC-PP201-113.5	TC-PA201-113.5	TC-RB201-113.5	-		13.5							
TC-PP201-114	TC-PA201-114	TC-RB201-114	TC-AL201-114		14							
TC-PP201-115	TC-PA201-115	TC-RB201-115	TC-AL201-115		15							
TC-PP201-116	TC-PA201-116	TC-RB201-116	TC-AL201-116		16							
TC-PP201-117.2	TC-PA201-117.2	TC-RB201-117.2	TC-AL201-117.2		17.2							
TC-PP201-118	TC-PA201-118	TC-RB201-118	TC-AL201-118		18							
TC-PP201-219	TC-PA201-219	TC-RB201-219	TC-AL201-219		19							
TC-PP201-220	TC-PA201-220	TC-RB201-220	TC-AL201-220	20								
TC-PP201-221.3	TC-PA201-221.3	TC-RB201-221.3	TC-AL201-221.3	21.3								
TC-PP201-222	TC-PA201-222	TC-RB201-222	TC-AL201-222	22								
TC-PP201-225	TC-PA201-225	TC-RB201-225	TC-AL201-225	25								
TC-PP201-225.4	TC-PA201-225.4	TC-RB201-225.4	-	25.4								
TC-PP201-226.9	TC-PA201-226.9	TC-RB201-226.9	TC-AL201-226.9	26.9								
TC-PP201-228	TC-PA201-228	TC-RB201-228	TC-AL201-228	28								
TC-PP201-230	TC-PA201-230	TC-RB201-230	TC-AL201-230	30								
TC-PP201-330	TC-PA201-330	TC-RB201-330	TC-AL201-330	30	3	30	85	60	60	100	8	M10 x 70
TC-PP201-332	TC-PA201-332	TC-RB201-332	TC-AL201-332	32								
TC-PP201-333.7	TC-PA201-333.7	TC-RB201-333.7	TC-AL201-333.7	33.7								
TC-PP201-335	TC-PA201-335	TC-RB201-335	TC-AL201-335	35								
TC-PP201-338	TC-PA201-338	TC-RB201-338	TC-AL201-338	38								
TC-PP201-340	TC-PA201-340	TC-RB201-340	TC-AL201-340	40								
TC-PP201-342	TC-PA201-342	TC-RB201-342	TC-AL201-342	42								
TC-PP201-342.4	TC-PA201-342.4	TC-RB201-342.4	TC-AL201-342.4	42.4								
TC-PP201-438	TC-PA201-438	TC-RB201-438	TC-AL201-438	38	4	45	120	90	90	140	10	M12 x 100
TC-PP201-442	TC-PA201-442	TC-RB201-442	-	42								
TC-PP201-442.4	TC-PA201-442.4	TC-RB201-442.4	TC-AL201-442.4	42.4								
TC-PP201-444.5	TC-PA201-444.5	TC-RB201-444.5	TC-AL201-444.5	44.5								
TC-PP201-448.3	TC-PA201-448.3	TC-RB201-448.3	TC-AL201-448.3	48.3								
TC-PP201-448.3	TC-PA201-448.3	TC-RB201-448.3	TC-AL201-448.3	48.3								

INDUSTRIAL FITTINGS - clips, clamps, ferrules

201 type

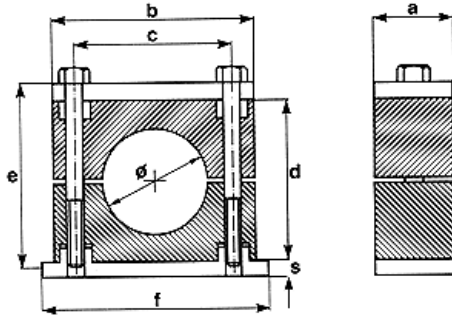

DIN 3015 heavy duty clamp

Clamp material: Green polypropylene (also: self-extinguishing polyamide, aluminium, rubber)

Bolts material: Galvanized steel

Plate material: Galvanized steel

Base material: Carbon steel

Designed for quick, easy, durable and esthetic assembly of pipes, cables and hoses. Apart from standard metal parts, extended plates, rails and bolts for clamp sets are available as well. For proper selection of elements, contact Sales or Technical Department of TUBES INTERNATIONAL®.

code (polypropylene)	code (polyamide)	code (rubber)	code (aluminium)	group	pipe O.D. [mm]	dimensions						
						a	b	c	d	f	s	e
TC-PP201-450	TC-PA201-450	TC-RB201-450	TC-AL201-450	4	50	45	120	90	90	140	10	M12 x 100
TC-PP201-450.8	TC-PA201-450.8	TC-RB201-450.8	-		50.8							
TC-PP201-455	TC-PA201-455	TC-RB201-455	TC-AL201-455		55							
TC-PP201-457	TC-PA201-457	TC-RB201-457	TC-AL201-457		57							
TC-PP201-460.3	TC-PA201-460.3	TC-RB201-460.3	TC-AL201-460.3		60.3							
TC-PP201-463.5	TC-PA201-463.5	TC-RB201-463.5	TC-AL201-463.5		63.5							
TC-PP201-465	TC-PA201-465	TC-RB201-465	TC-AL201-465		65							
TC-PP201-470	TC-PA201-470	TC-RB201-470	TC-AL201-470		70							
TC-PP201-565	TC-PA201-565	TC-RB201-565	TC-AL201-565	5	65	60	152	122	120	180	10	M16 x 130
TC-PP201-570	TC-PA201-570	TC-RB201-570	TC-AL201-570		70							
TC-PP201-575	TC-PA201-575	TC-RB201-575	TC-AL201-575		75							
TC-PP201-576.1	TC-PA201-576.1	TC-RB201-576.1	TC-AL201-576.1		76.1							
TC-PP201-580	TC-PA201-580	TC-RB201-580	TC-AL201-580		80							
TC-PP201-582.5	TC-PA201-582.5	TC-RB201-582.5	TC-AL201-582.5		80							
TC-PP201-588.9	TC-PA201-588.9	TC-RB201-588.9	TC-AL201-588.9	88.9								
TC-PP201-688.9	TC-PA201-688.9	TC-RB201-688.9	-	6	88.9	80	205	168	170	225	15	M20 x 190
TC-PP201-6100	TC-PA201-6100	TC-RB201-6100	-		100							
TC-PP201-6101.6	TC-PA201-6101.6	TC-RB201-6101.6	-		101.6							
TC-PP201-6108	TC-PA201-6108	TC-RB201-6108	-		108							
TC-PP201-6114.3	TC-PA201-6114.3	TC-RB201-6114.3	-		114.3							
TC-PP201-6127	TC-PA201-6127	TC-RB201-6127	-		127							
TC-PP201-6133	TC-PA201-6133	TC-RB201-6133	-	133								
TC-PP201-7133	TC-PA201-7133	TC-RB201-7133	-	7	133	90	250	205	200	270	15	M24 x 220
TC-PP201-7139.7	TC-PA201-7139.7	TC-RB201-7139.7	-		139.7							
TC-PP201-7152.4	TC-PA201-7152.4	TC-RB201-7152.4	-		152.4							
TC-PP201-7165	TC-PA201-7165	TC-RB201-7165	-		165							
TC-PP201-7168.3	TC-PA201-7168.3	TC-RB201-7168.3	-		168.3							
TC-PP201-8168.3	-	-	-	8	168.3	120	320	265	270	340	25	M30 x 300
TC-PP201-8177.8	-	-	-		177.8							
TC-PP201-8193.7	-	-	-		193.7							
TC-PP201-8216	-	-	-		216							
TC-PP201-8219.1	-	-	-		219.1							

INDUSTRIAL FITTINGS - clips, clamps, ferrules

301 type

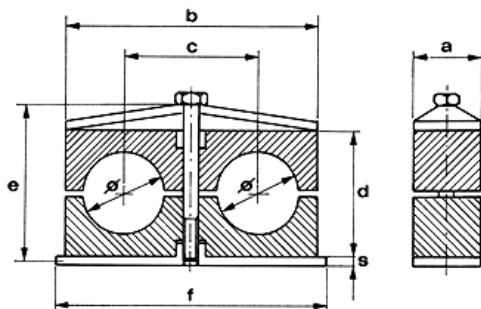

DIN 3015 double clamp

Clamp material: Green polypropylene (also: self-extinguishing polyamide, rubber)

Bolts material: Galvanized steel

Plate material: Galvanized steel

Base material: Carbon steel

Designed for quick, easy, durable and esthetic assembly of pipes, cables and hoses. Apart from standard metal parts, extended plates, rails and bolts for clamp sets are available as well. For proper selection of elements, contact Sales or Technical Department of TUBES INTERNATIONAL®.

code (polypropylene)	code (polyamide)	code (rubber)	code (aluminium)	group	pipe O.D. [mm]	dimensions						
						a	b	c	d	f	s	e
TC-PP301-106	TC-PA301-106	TC-RB301-106	-	1	6 x 6	30	37	20	25	37	3	M6 x 35
TC-PP301-106.4	TC-PA301-106.4	TC-RB301-106.4	-		6.4 x 6.4							
TC-PP301-108	TC-PA301-108	TC-RB301-108	-		8 x 8							
TC-PP301-109.5	TC-PA301-109.5	TC-RB301-109.5	-		9.5 x 9.5							
TC-PP301-110	TC-PA301-110	TC-RB301-110	-		10 x 10							
TC-PP301-112	TC-PA301-112	TC-RB301-112	-		12 x 12							
TC-PP301-212.7	TC-PA301-212.7	TC-RB301-212.7	-	2	12.7 x 12.7	30	53	29	26	55	5	M8 x 35
TC-PP301-213.5	TC-PA301-213.5	TC-RB301-213.5	-		13.5 x 13.5							
TC-PP301-214	TC-PA301-214	TC-RB301-214	-		14 x 14							
TC-PP301-215	TC-PA301-215	TC-RB301-215	-		15 x 15							
TC-PP301-216	TC-PA301-216	TC-RB301-216	-		16 x 16							
TC-PP301-217.2	TC-PA301-217.2	TC-RB301-217.2	-		17.2 x 17.2							
TC-PP301-218	TC-PA301-218	TC-RB301-218	-	18 x 18	30	67	36	37	70	5	M8 x 45	
TC-PP301-319	TC-PA301-319	TC-RB301-319	-	19 x 19								
TC-PP301-320	TC-PA301-320	TC-RB301-320	-	20 x 20								
TC-PP301-321.3	TC-PA301-321.3	TC-RB301-321.3	-	21.3 x 21.3								
TC-PP301-322	TC-PA301-322	TC-RB301-322	-	22 x 22								
TC-PP301-325	TC-PA301-325	TC-RB301-325	-	25 x 25								
TC-PP301-325.4	TC-PA301-325.4	TC-RB301-325.4	-	25.4 x 25.4	30	82	45	42	85	5	M8 x 50	
TC-PP301-426.9	TC-PA301-426.9	TC-RB301-426.9	-	26.9 x 26.9								
TC-PP301-428	TC-PA301-428	TC-RB301-428	-	28 x 28								
TC-PP301-430	TC-PA301-430	TC-RB301-430	-	30 x 30	30	106	56	54	110	5	M8 x 60	
TC-PP301-532	TC-PA301-532	TC-RB301-532	-	32 x 32								
TC-PP301-533.7	TC-PA301-533.7	TC-RB301-533.7	-	33.7 x 33.7								
TC-PP301-535	TC-PA301-535	TC-RB301-535	-	35 x 35								
TC-PP301-538	TC-PA301-538	TC-RB301-538	-	38 x 38								
TC-PP301-540	TC-PA301-540	TC-RB301-540	-	40 x 40								
TC-PP301-542	TC-PA301-542	TC-RB301-542	-	42 x 42	30	106	56	54	110	5	M8 x 60	
TC-PP301-542.4	TC-PA301-542.4	TC-RB301-542.4	-	42.4 x 42.4								

INDUSTRIAL FITTINGS - clips, clamps, ferrules

DIN 3015 clamps - mounting elements

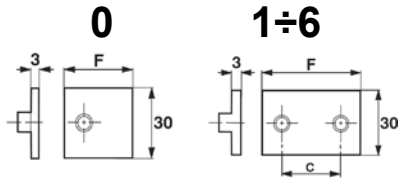
		code (galv. steel)	code (AISI 316L)	group	c [mm]	F [mm]
		TC-APIN-0	TC-APIN-0-SS	0	-	32
		TC-APIN-1	TC-APIN-1-SS	1	20	42
		TC-APIN-2	TC-APIN-2-SS	2	26	48
		TC-APIN-3	TC-APIN-3-SS	3	33	55
		TC-APIN-4	TC-APIN-4-SS	4	40	62
		TC-APIN-5	TC-APIN-5-SS	5	52	74
		TC-APIN-6	TC-APIN-6-SS	6	66	88

Standard clamp - short lower plate
for complete clamps 100, 101 type

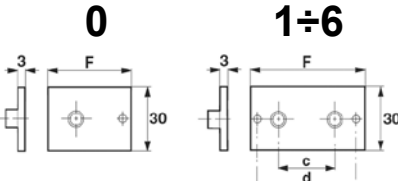
		code (galv. steel)	code (AISI 316L)	group	F [mm]	c [mm]	d [mm]
		TC-APIA-0	TC-APIA-0-SS	0	46	-	-
		TC-APIA-1	TC-APIA-1-SS	1	64	20	51
		TC-APIA-2	TC-APIA-2-SS	2	70	26	56
		TC-APIA-3	TC-APIA-3-SS	3	78	33	64
		TC-APIA-4	TC-APIA-4-SS	4	86	40	71
		TC-APIA-5	TC-APIA-5-SS	5	97	52	83
		TC-APIA-6	TC-APIA-6-SS	6	112	66	100

Standard clamp - long lower plate

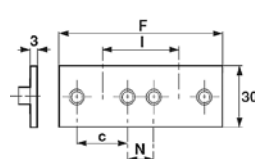
		code (galv. steel)	code (AISI 316L)	group	F [mm]	c [mm]	N [mm]	l [mm]	no. of clamps
		TC-APID-0	TC-APID-0-SS	0	61	-	-	30	2
		TC-APID-1	TC-APID-1-SS	1	81	20	20	40	2
		TC-APID-2	TC-APID-2-SS	2	91	26	18	44	2
		TC-APID-3	TC-APID-3-SS	3	106	33	19	52	2
		TC-APID-4	TC-APID-4-SS	4	121	40	20	60	2
		TC-APID-5	TC-APID-5-SS	5	148	52	23	75	2
		TC-APID-6	TC-APID-6-SS	6	177	66	24	90	2

Standard clamp - double lower plate

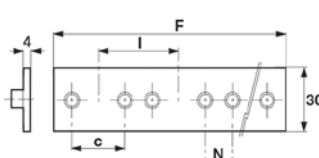
		code (galv. steel)	code (AISI 316L)	group	F [mm]	c [mm]	N [mm]	l [mm]	no. of clamps
		TC-APIM-0	TC-APIM-0-SS	0	306	-	-	30	10
		TC-APIM-1	TC-APIM-1-SS	1	404	20	20	40	10
		TC-APIM-2	TC-APIM-2-SS	2	447	26	18	44	10
		TC-APIM-3	TC-APIM-3-SS	3	525	33	19	52	10
		TC-APIM-4	TC-APIM-4-SS	4	303	40	20	60	5
		TC-APIM-5	TC-APIM-5-SS	5	375	52	23	75	5
		TC-APIM-6	TC-APIM-6-SS	6	447	66	24	90	5

Standard clamp - multiple lower plate

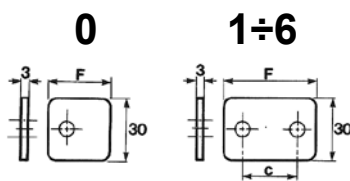
		code (galv. steel)	code (AISI 316L)	group	c [mm]	F [mm]
		TC-APS-0	TC-APS-0-SS	0	-	28
		TC-APS-1	TC-APS-1-SS	1	20	37
		TC-APS-2	TC-APS-2-SS	2	26	43
		TC-APS-3	TC-APS-3-SS	3	33	50
		TC-APS-4	TC-APS-4-SS	4	40	57
		TC-APS-5	TC-APS-5-SS	5	52	69
		TC-APS-6	TC-APS-6-SS	6	66	83

Standard clamp - upper plate
for complete clamps 101 type

INDUSTRIAL FITTINGS - clips, clamps, ferrules

DIN 3015 clamps - mounting elements

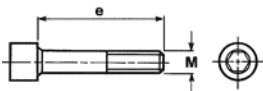
 <p>Standard clamp - allen screw for complete clamps 100 type</p>	code (galv. steel)	code (AISI 304)	group	M [mm]	e [mm]
	TC-AVTC-0	TC-AVTC-0-SS	0	M6	20
	TC-AVTC-1	TC-AVTC-1-SS	1	M6	20
	TC-AVTC-2	TC-AVTC-2-SS	2	M6	25
	TC-AVTC-3	TC-AVTC-3-SS	3	M6	30
	TC-AVTC-4	TC-AVTC-4-SS	4	M6	35
	TC-AVTC-5	TC-AVTC-5-SS	5	M6	50
	TC-AVTC-6	TC-AVTC-6-SS	6	M6	60

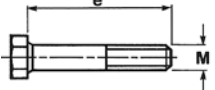
 <p>Standard clamp - screw (hexagonal) for complete clamps 101 type</p>	code (galv. steel)	code (AISI 304)	group	M [mm]	e [mm]
	TC-AVTE-0	TC-AVTE-0-SS	0	M6	30
	TC-AVTE-1	TC-AVTE-1-SS	1	M6	30
	TC-AVTE-2	TC-AVTE-2-SS	2	M6	35
	TC-AVTE-3	TC-AVTE-3-SS	3	M6	40
	TC-AVTE-4	TC-AVTE-4-SS	4	M6	45
	TC-AVTE-5	TC-AVTE-5-SS	5	M6	60
	TC-AVTE-6	TC-AVTE-6-SS	6	M6	70

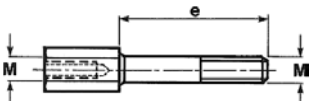
 <p>Standard clamp - stacking screw</p>	code (galv. steel)	code (AISI 304)	group	M [mm]	e [mm]
	TC-AVTEA-0	TC-AVTEA-0	0	M6	20
	TC-AVTEA-1	TC-AVTEA-1	1	M6	20
	TC-AVTEA-2	TC-AVTEA-2	2	M6	25
	TC-AVTEA-3	TC-AVTEA-3	3	M6	30
	TC-AVTEA-4	TC-AVTEA-4	4	M6	35
	TC-AVTEA-5	TC-AVTEA-5	5	M6	50
	TC-AVTEA-6	TC-AVTEA-6	6	M6	60

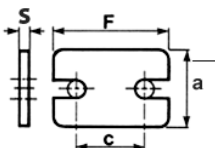
 <p>Standard clamp - stacking security plate</p>	code (galv. steel)	code (AISI 316L)	group	F [mm]	c [mm]
	TC-APMRS-0	TC-APMRS-0	0	28	-
	TC-APMRS-1	TC-APMRS-1	1	34	20
	TC-APMRS-2	TC-APMRS-2	2	41	26
	TC-APMRS-3	TC-APMRS-3	3	47	33
	TC-APMRS-4	TC-APMRS-4	4	57	40
	TC-APMRS-5	TC-APMRS-5	5	67	52
	TC-APMRS-6	TC-APMRS-6	6	82	66

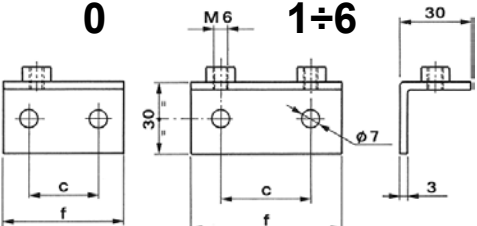
 <p>Standard clamp - angular lower plate</p>	code (galv. steel)	code (AISI 316L)	group	c [mm]	f [mm]
	TC-APINL-0	TC-APINL-0	0	14	32
	TC-APINL-1	TC-APINL-1	1	20	42
	TC-APINL-2	TC-APINL-2	2	26	48
	TC-APINL-3	TC-APINL-3	3	33	55
	TC-APINL-4	TC-APINL-4	4	40	62
	TC-APINL-5	TC-APINL-5	5	52	74
	TC-APINL-6	TC-APINL-6	6	66	88

INDUSTRIAL FITTINGS - clips, clamps, ferrules

DIN 3015 clamps - mounting elements

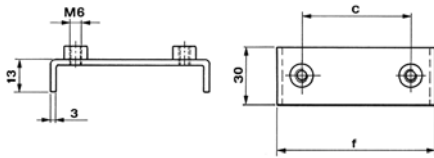
 <p>Standard clamp - bridge lower plate</p>	code (galv. steel)	code (AISI 316L)	group	c [mm]	f [mm]
	TC-APINB-1	TC-APINB-1-SS	1	20	48
	TC-APINB-2	TC-APINB-2-SS	2	26	54
	TC-APINB-3	TC-APINB-3-SS	3	33	62
	TC-APINB-4	TC-APINB-4-SS	4	40	71
	TC-APINB-5	TC-APINB-5-SS	5	52	85
	TC-APINB-6	TC-APINB-6-SS	6	66	98

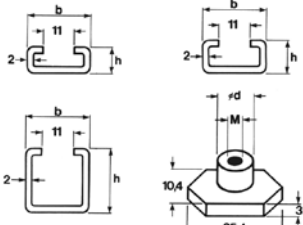
 <p>Double and standard clamp - rails and nuts</p>	code (galv. steel)	code (AISI 304)	standard group	double group	b [mm]	h [mm]	length [m]
	TC-ABINS-1	TC-ABINS-1-SS	0÷6	1÷5	28	11	1 or 2
	TC-ABINS-2	TC-ABINS-2-SS			28	14	1 or 2
	TC-ABINS-3	TC-ABINS-3-SS			28	30	1 or 2
	TC-ADES	TC-ADES-SS	1	nut for guide rails (M6, d = 12)			
	TC-ADESD	TC-ADESD-SS	2÷5	nut for guide rails (M8, d = 14)			

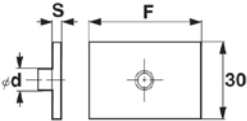
 <p>Double clamp - short lower plate for double complete clamps 301 type</p>	code (galv. steel)	code (AISI 304)	group	S [mm]	d [mm]	F [mm]
	TC-ADPIN-1	TC-ADPIN-1-SS	1	3	12	37
	TC-ADPIN-2	TC-ADPIN-2-SS	2	5	14	55
	TC-ADPIN-3	TC-ADPIN-3-SS	3	5	14	70
	TC-ADPIN-4	TC-ADPIN-4-SS	4	5	14	85
	TC-ADPIN-5	TC-ADPIN-5-SS	5	5	14	110

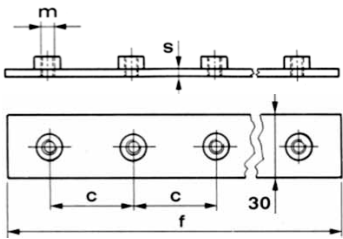
 <p>Double clamp - multiple lower plate</p>	code (galv. steel)	code (AISI 316L)	group	f [mm]	c [mm]	s [mm]	m [mm]	no. of clamps
	TC-ADPIM-1	TC-ADPIM-1-SS	1	200	40	3	M6	5
	TC-ADPIM-2	TC-ADPIM-2-SS	2	290	58	5	M8	5
	TC-ADPIM-3	TC-ADPIM-3-SS	3	360	72	5	M8	5
	TC-ADPIM-4	TC-ADPIM-4-SS	4	450	90	5	M8	5
	TC-ADPIM-5	TC-ADPIM-5-SS	5	560	112	5	M8	5

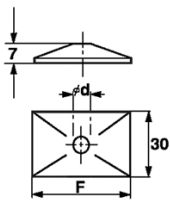
 <p>Double clamp - upper plate for double complete clamps 301 type</p>	code (galv. steel)	code (AISI 316L)	group	F [mm]	d [mm]
	TC-ADPS-1	TC-ADPS-1-SS	1	35	7
	TC-ADPS-2	TC-ADPS-2-SS	2	52	9
	TC-ADPS-3	TC-ADPS-3-SS	3	66	9
	TC-ADPS-4	TC-ADPS-4-SS	4	81	9
	TC-ADPS-5	TC-ADPS-5-SS	5	105	9

INDUSTRIAL FITTINGS - clips, clamps, ferrules

DIN 3015 clamps - mounting elements

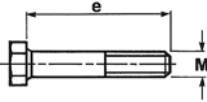
 <p>Double clamp - screw (hexagonal) for double complete clamps 301 type</p>	code (galv. steel)	code (AISI 304)	group	M [mm]	e [mm]
	TC-ADVTE-1	TC-ADVTE-1-SS	1	M6	35
	TC-ADVTE-2	TC-ADVTE-2-SS	2	M8	35
	TC-ADVTE-3	TC-ADVTE-3-SS	3	M8	45
	TC-ADVTE-4	TC-ADVTE-4-SS	4	M8	50
	TC-ADVTE-5	TC-ADVTE-5-SS	5	M8	60

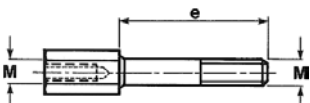
 <p>Double clamp - stacking screw</p>	code (galv. steel)	code (AISI 304)	group	M [mm]	e [mm]
	TC-ADVTEA-1	TC-ADVTEA-1-SS	1	M6	20
	TC-ADVTEA-2	TC-ADVTEA-2-SS	2	M8	20
	TC-ADVTEA-3	TC-ADVTEA-3-SS	3	M8	29
	TC-ADVTEA-4	TC-ADVTEA-4-SS	4	M8	34
	TC-ADVTEA-5	TC-ADVTEA-5-SS	5	M8	47

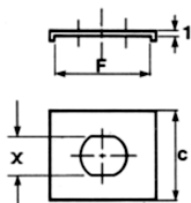
 <p>Double clamp - stacking security plate</p>	code (galv. steel)	code (AISI 316L)	group	F [mm]	c [mm]	X [mm]
	TC-APMRSD-1	TC-APMRSD-1-SS	1	30	30	11
	TC-APMRSD-2-5	TC-APMRSD-2-5-SS	2+5	30	30	13

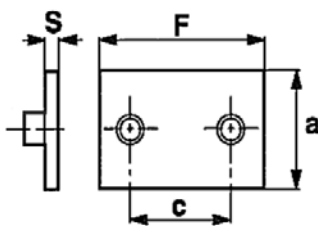
 <p>Heavy clamp - short lower plate for heavy complete clamps 201 type</p>	code (galv. steel)	code (AISI 316L)	group	a [mm]	F [mm]	c [mm]	S [mm]
	TC-APINP-1	TC-APINP-1-SS	1	30	75	33	8
	TC-APINP-2	TC-APINP-2-SS	2	30	87	45	8
	TC-APINP-3	TC-APINP-3-SS	3	30	102	60	8
	TC-APINP-4	TC-APINP-4-SS	4	45	140	80	10
	TC-APINP-5	TC-APINP-5-SS	5	60	180	122	10
	TC-APINP-6	TC-APINP-6-SS	6	80	225	168	15
	TC-APINP-7	TC-APINP-7-SS	7	90	270	205	15
	TC-APINP-8	TC-APINP-8-SS	8	120	340	265	25

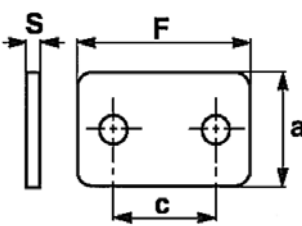
 <p>Heavy clamp - upper plate for heavy complete clamps 201 type</p>	code (galv. steel)	code (AISI 316L)	group	a [mm]	F [mm]	c [mm]	S [mm]
	TC-APSP-1	TC-APSP-1-SS	1	30	55	33	8
	TC-APSP-2	TC-APSP-2-SS	2	30	70	45	8
	TC-APSP-3	TC-APSP-3-SS	3	30	85	60	8
	TC-APSP-4	TC-APSP-4-SS	4	45	120	80	10
	TC-APSP-5	TC-APSP-5-SS	5	60	152	122	10
	TC-APSP-6	TC-APSP-6-SS	6	80	205	168	15
	TC-APSP-7	TC-APSP-7-SS	7	90	250	205	15
	TC-APSP-8	TC-APSP-8-SS	8	120	320	265	25

INDUSTRIAL FITTINGS - clips, clamps, ferrules

DIN 3015 clamps - mounting elements

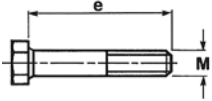

Heavy clamp - screw (hexagonal)
for heavy complete clamps 201 type

code (galv. steel)	code (AISI 304)	group	M [mm]	e [mm]
TC-AVTEP-1	TC-AVTEP-1-SS	1	M10	45
TC-AVTEP-2	TC-AVTEP-2-SS	2	M10	60
TC-AVTEP-3	TC-AVTEP-3-SS	3	M10	70
TC-AVTEP-4	TC-AVTEP-4-SS	4	M12	100
TC-AVTEP-5	TC-AVTEP-5-SS	5	M16	130
TC-AVTEP-6	TC-AVTEP-6-SS	6	M20	190
TC-AVTEP-7	TC-AVTEP-7-SS	7	M24	220
TC-AVTEP-8	TC-AVTEP-8-SS	8	M30	300

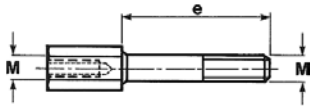

Heavy clamp - stacking screw

code (galv. steel)	code (AISI 304)	group	M [mm]	e [mm]
TC-AVTEAP-1	TC-AVTEAP-1-SS	1	M10	26
TC-AVTEAP-2	TC-AVTEAP-2-SS	2	M10	41
TC-AVTEAP-3	TC-AVTEAP-3-SS	3	M10	52
TC-AVTEAP-4	TC-AVTEAP-4-SS	4	M12	83
TC-AVTEAP-5	TC-AVTEAP-5-SS	5	M16	110

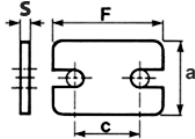

Heavy clamp - stacking security plate

code (galv. steel)	code (AISI 316L)	group	a [mm]	F [mm]	c [mm]	S [mm]
TC-APMRSP-1	TC-APMRSP-1-SS	1	30	55	33	8
TC-APMRSP-2	TC-APMRSP-2-SS	2	30	70	45	8
TC-APMRSP-3	TC-APMRSP-3-SS	3	30	85	60	8
TC-APMRSP-4	TC-APMRSP-4-SS	4	45	120	90	10
TC-APMRSP-5	TC-APMRSP-5-SS	5	60	152	122	10

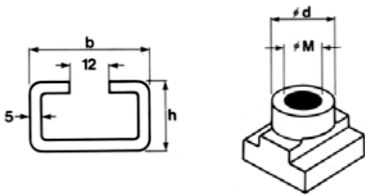

Heavy clamp - rails and nuts

code (galv. steel)	code (AISI 316L)	group	b [mm]	h [mm]	length [m]
TC-ABINP-1	TC-ABINP-1-SS	1+4	40	22	1 or 2
TC-ADESP-1	TC-ADESP-1-SS	1+3	nut for guide rails (M10, d = 18)		
TC-ADESP-2	TC-ADESP-2-SS	4	nut for guide rails (M12, d = 20)		

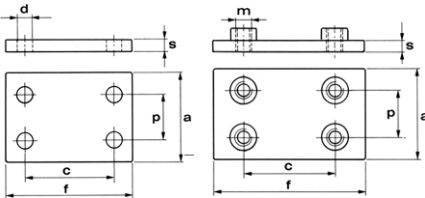

Heavy clamp - upper and lower double plate

code (galv. steel)	code (AISI 316L)	group	a [mm]	f [mm]	s [mm]	c [mm]	p [mm]	d/m [mm]
TC-APSPD-1	TC-APSPD-1-SS	1	60	56	8	33	31	11
TC-APSPD-2	TC-APSPD-2-SS	2	60	70	8	45	31	11
TC-APSPD-3	TC-APSPD-3-SS	3	60	85	8	60	31	11
TC-APSPD-4	TC-APSPD-4-SS	4	90	116	10	90	46	14
TC-APSPD-5	TC-APSPD-5-SS	5	120	153	10	122	61	18
TC-APINPD-1	TC-APINPD-1-SS	1	60	74	8	33	31	M10
TC-APINPD-2	TC-APINPD-2-SS	2	60	86	8	45	31	M10
TC-APINPD-3	TC-APINPD-3-SS	3	60	100	8	60	31	M10
TC-APINPD-4	TC-APINPD-4-SS	4	90	140	10	90	46	M12
TC-APINPD-5	TC-APINPD-5-SS	5	120	180	10	122	61	M16